

BACK VIEW

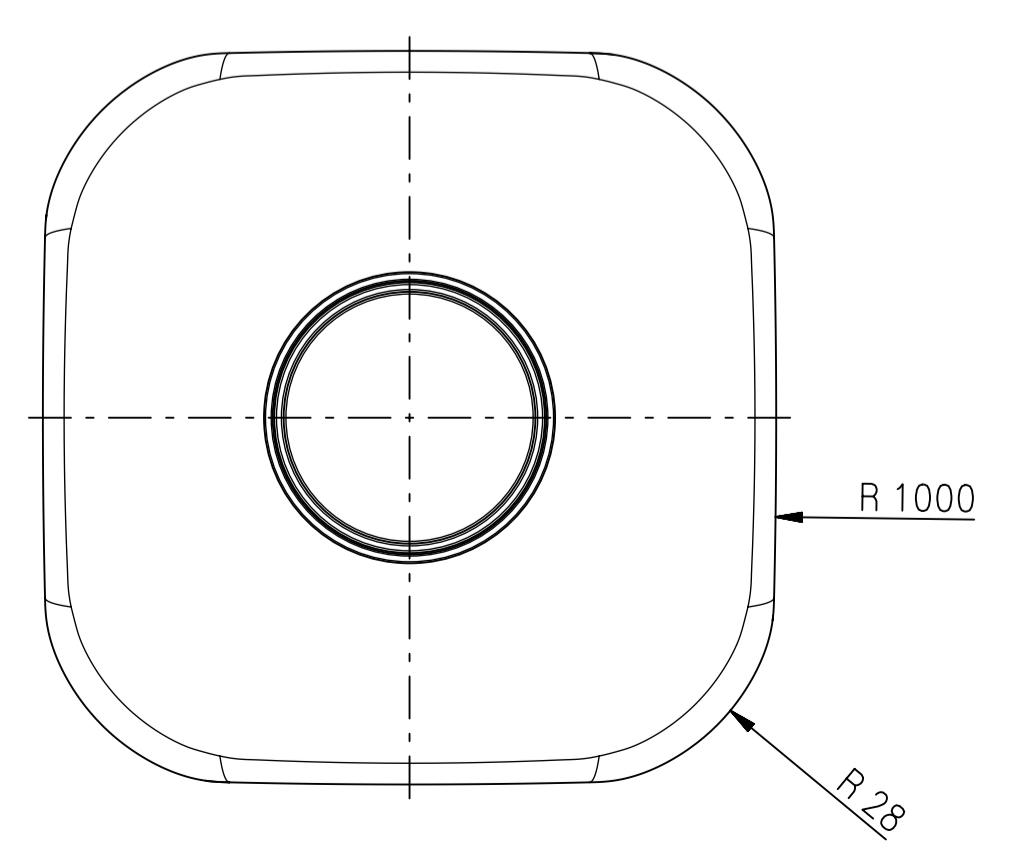
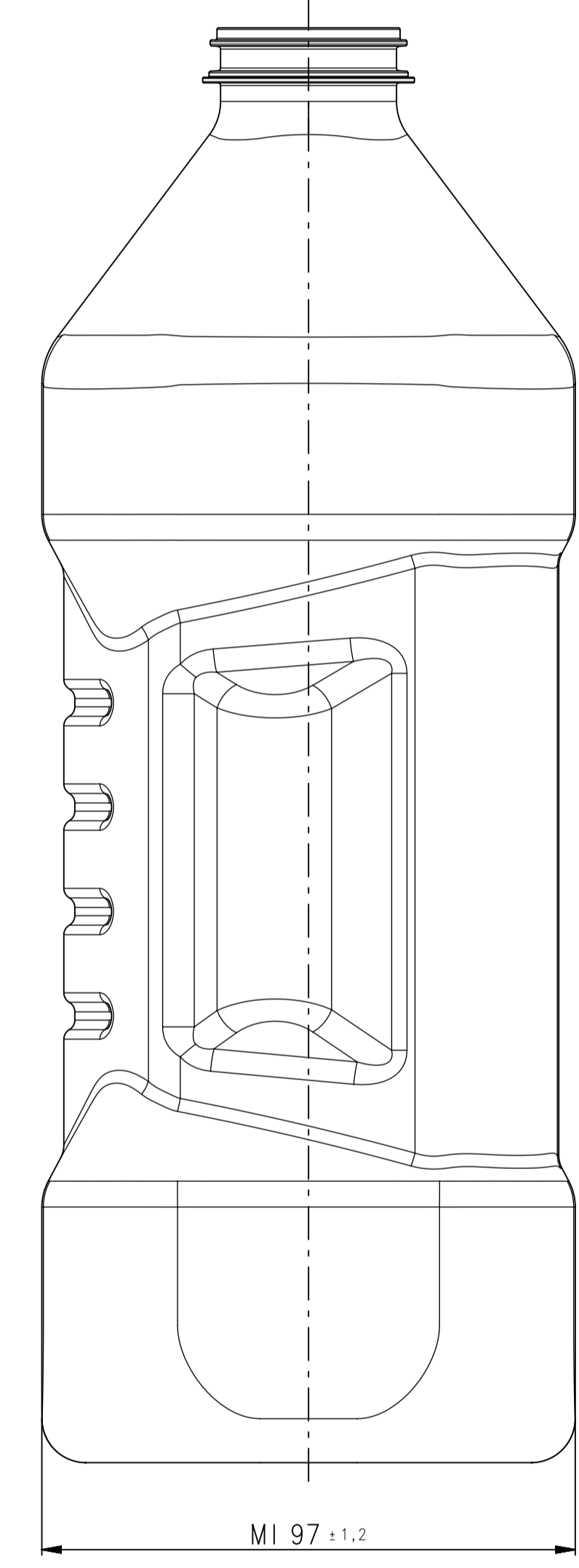
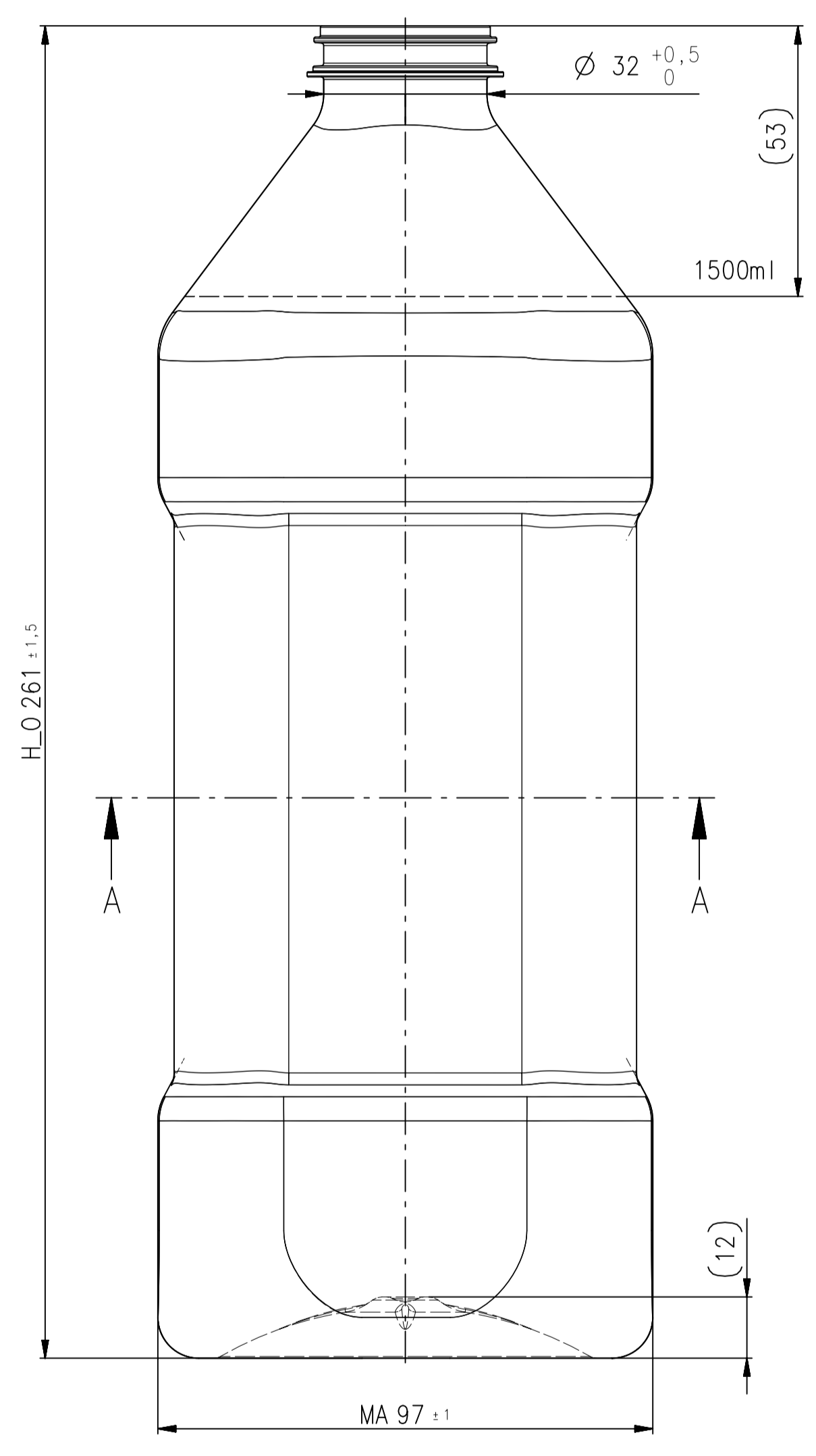
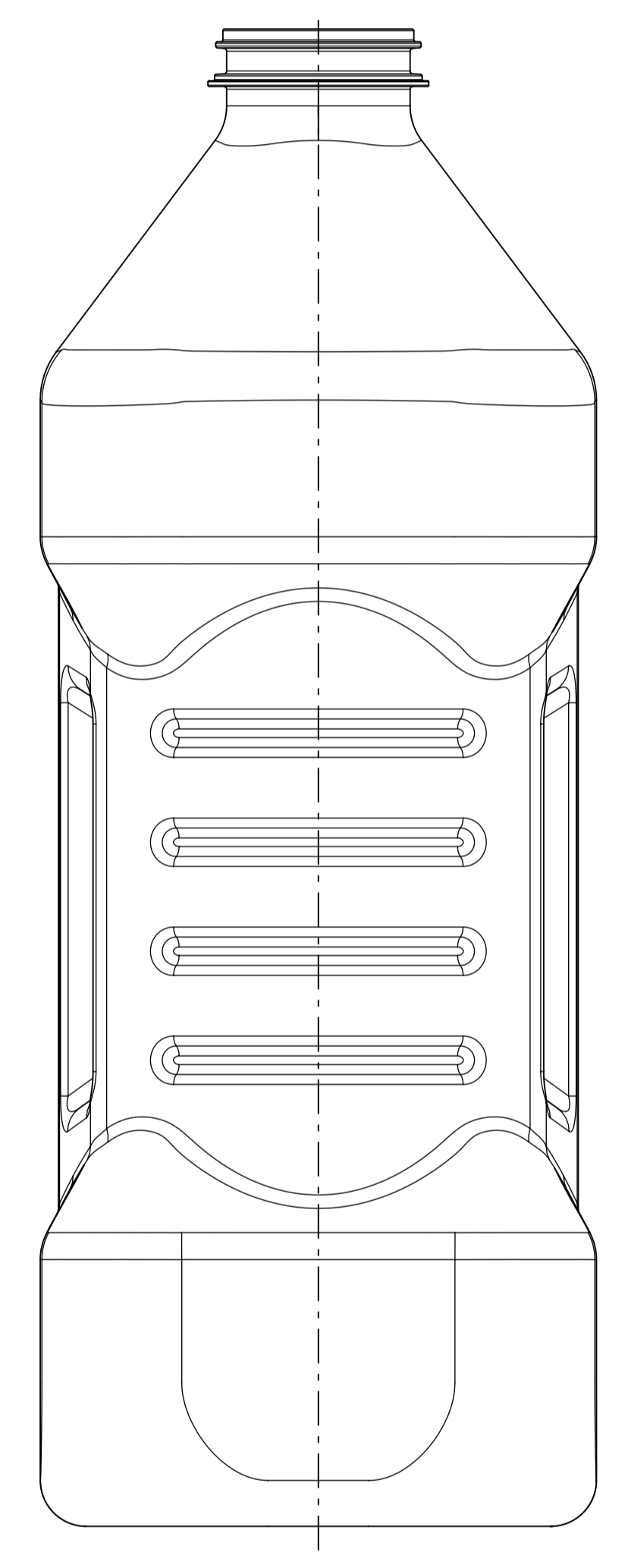

MATERIAL: PET
 WEIGHT: 69 ± 1g
 VOLUME: 1630 ± 30ml BRIMFULL

STRETCHED LENGTH: 321,8mm
 STRETCHED LENGTH (OVER CORNER): 320,8mm
 AVERAGE CIRCUMFERENCE: 342,2mm
 BASE CIRCUMFERENCE: 264,6 mm

SURFACE AREA BELOW SR: 87551,2mm²
 SURFACE AREA: 89571,1 mm²

General Tolerance DIN ISO 2768 Forming article: DIN 2533 Preform: DIN 2537/2538	03a	USR dia. updated	STS	10.Jul.23	04a	Food Symbol Added	STS	17.Jul.23
	01a	USR dia. updated	STS	22.Jun.23	02a	USR dia. updated	STS	29.Jun.23
	Index/Modification:		Name	Date	Index/Modification:		Name	Date
	Scale:	1:1	Name	Stocker Simon	Date	31.May.23		
Prepared:		3:1	Reviewed:	KJ	31.May.23			
ALPLA reserves all rights to the technical IP contained in the document		Supersedes:						
Title:		Weight:		0,00kg				
Art.No.:		Page:		1 of 1				
Drawing No.:		Revision:		04				
Olio 1500ml PET		9402_023_022_01						